

Component Parts

1. Body Casting
2. Hopper
3. Hopper Cap
4. Cylinder
5. Micrometer
(rifle or pistol)
6. Handle
7. Cylinder Screw
8. Handle Screw
9. Hopper Screw
10. Lock Ring
11. Lock Ring Screw
12. Nylon Ball

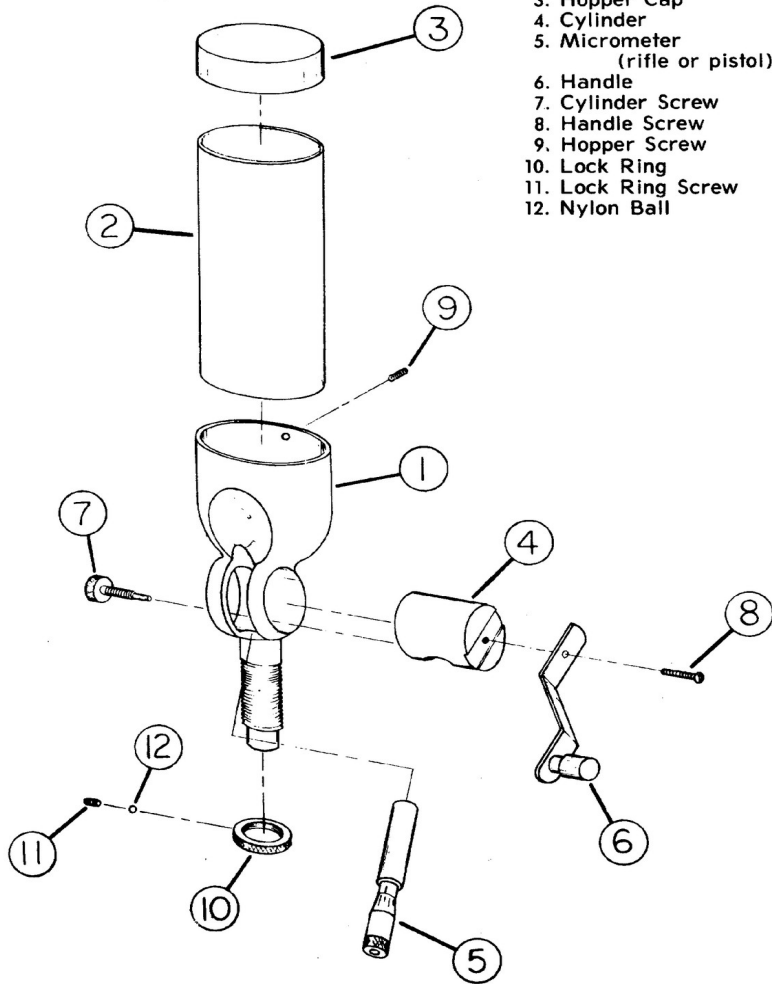

502 Powder Measure



Your CH No. 502 Powder Measure is shipped completely assembled. It is supplied with a universal drop tube which will handle all cases from 22 to 50 caliber.

The Powder Measure is lightly coated with a rust preventative. Remove the cylinder and wipe off with a highly volatile solvent before use. The micrometer assembly should also be wiped off at this time. The cylinder is easily removed by taking out the lock screw on the side of the cylinder. After removing this screw the complete micrometer can be pulled out of the cylinder. Reverse the above procedure to assemble your measure.

The measure body is threaded 7/8 x 14, and can be used with our No. 502-1 measure stand or can be used in a die station on your loading tool. Before using the measure it is a good idea to run about a pound of powder through the measure to coat the inside of the casting. This will result in a more even flow of powder, thus obtaining more accurate charges. The micrometer should be set at maximum during this procedure.

The basic measure is furnished with a 'rifle' micrometer, and can be used for all charges from 2 grains to 100 grains. A 'pistol' micrometer is available for more accurate charges of pistol powders, and will throw a maximum of 16 grains. We highly recommend this optional pistol micrometer when using fine grained pistol powders.

The micrometer is graduated for easy reference when returning to charges previously thrown. These readings can be recorded to make it easy to return to a setting.

After determining what powder charge you want to use, loosen the lock screw on the side of the cylinder just enough to free the micrometer. Turn the micrometer counter-clockwise to increase the charge and clockwise to decrease the charge. Once the proper charge is attained, throw several charges and check them against a good scale. Charges from the measure should be checked periodically throughout the loading sequence.

If clogging of the drop tube occurs with long kernel powders a light knock with the handle at the top and bottom of the stroke will usually prevent this.

The No. 502 Powder Measure can be used with either an up-stroke or down-stroke motion. Removing the lock screw on the handle and rotating it 180 degrees will instantly convert it to one or the other. By removing the main cylinder and reversing it, the measure instantly becomes a left hand model, either up or down stroke.

To convert from the 'rifle' type micrometer to the 'pistol' type, remove the large lock screw from the cylinder and remove the micrometer assembly. Insert the pistol micrometer in the same manner, making sure the hole in the micrometer is lined up with the hole in the cylinder. Insert the lock screw to tighten the micrometer.

The key to highly accurate charges lies in the operation of the measure. A smooth, steady stroke of the handle is necessary. Uniformity in operating the measure is essential.

Do not lubricate the measure with a grease type lubricant. If you feel lubrication is necessary, use a powdered graphite type lube and use sparingly.

Always remove all powder from the measure when not in use.

CH Tool & Die LLC

711 N Sandusky St

Mt. Vernon, OH 43050

740-397-7214

<http://www.chtoolanddie.com>